



How to use Amiflex[®]



To learn more about Amiflex, SCAN THE CODE

What do I need to treat my hives with Amiflex?

- The Amiflex dosing gun (included in the "Starter Pack")
- Protective gloves (nitrile / vinyl)
- Protective glasses



• **Amiflex is a Restricted Use Pesticide.** It can only be used by certified applicators who have completed specialized training and are licensed by the state or federal government. If you are interested in learning more about pesticide safety regulations and certification programs in your state, [scan this QR code](#).

When can I apply Amiflex?

The product can be used any time when honey supers are not present and as long as the bees are actively foraging. Avoid treating in winter (The winter cluster is less likely to get in contact with the gel on the top bars):

- Before the first honey flow of the season.
- In-between two honey flows to clean up the hive(s) in spring.
- After the last honey flow in summer to quickly knock down varroa mite infestation before a long-term varroa treatment.
- In autumn, after the summer treatment and/or to reduce varroa mite infestation before overwintering.

Step-by-step guide

1. Clean frames clear of all wax and propolis that could prevent the bees from coming in contact with the gel. For example, clean top feeders and top bars of each brood box.

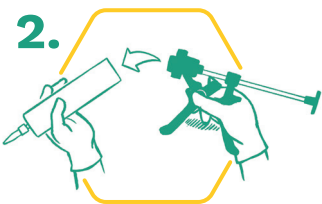

Remove the cap of the cartridge.



Load

the Amiflex dosing gun with one cartridge from the packaging.

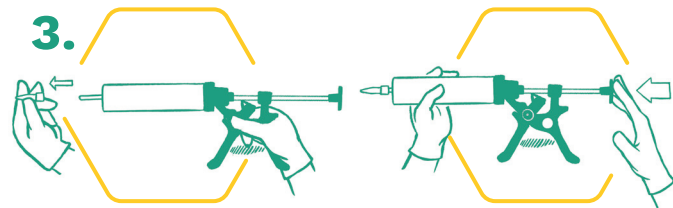

Gently and briefly depress the trigger several times **to prime** the dosing gun.

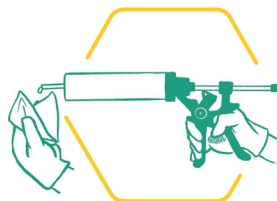

Remove the excess product.

Each pull of the dosing gun's trigger will release a standard dose of 3 ml of gel.

4.

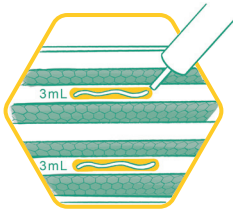

Place

two wooden supports (included in the packaging) on the top bars of the brood box and apply 3 ml of Amiflex gel on each of them.



For a single brood box, that makes 6 ml of gel in total.

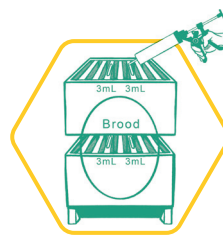

For a double brood box, that makes 12 ml of gel in total (6 ml per brood box).

5.

After 7 days, **remove** the wooden supports with the leftover gel. You can now set your honey supers up on the hive, as there is no withdrawal period with Amiflex (meaning you can put your supers on immediately).

Step 4

Apply 2 x 3 ml on the top bars of each brood box.

7 days

Step 5

Remove any remaining product. You can now set up honey supers.

IN CASE OF HIGH INFESTATION*, you can use up to two Amiflex applications in a row, with a 7-day break in-between:

FIRST APPLICATION
Apply 2x3 ml on the top bars of each brood.

WAIT FOR 7 days

Remove any remaining product from the first application.

WAIT FOR 7 days

SECOND APPLICATION IF INFESTATION IS HIGH
Apply 2x3 ml on the top bars of each brood.

WAIT FOR 7 days

Remove any remaining product from the second application. **You can now set up honey supers.**

21 DAYS

*Mite infestation levels that would usually be observed at the end of the season.

General recommendations

- You can apply Amiflex **up to 4 times a year** (4 times 1 application OR 2 times 2 applications OR 2 times 1 application + 1 time 2 applications), not exceeding two applications in a row.
- The Amiflex dosing gun is specially designed to deliver **3 ml of gel per pulse**. Please apply Amiflex only with the dosing gun included in the Amiflex "Starter Pack", to make sure you respect the correct dosage. Keep the dosing gun for later use: you will only need to purchase the Amiflex "Refill pack".
- Treat all hives from the same apiary at the same time.
- Rotate active ingredients during the year to preserve their efficacy.

Shelf life

The shelf life of an unopened Amiflex pack is **24 months** after manufacturing. **After opening the aluminum sachet containing the 10 cartridges**, we advise you to use all cartridges within 3 months.

Store unopened cartridges in a cool, dry area, away from direct sunlight and other pesticides that could potentially contaminate the product.

After initiating the first use of a cartridge, it is important to immediately use the Amiflex gel in this cartridge and discard any remaining unused product.

How to dispose of Amiflex?

The EPA label recommends that any unused or excess product should be disposed of according to state and local regulations. It is important to avoid contaminating water sources, and to not reuse or refill empty cartridges. Please check your local regulations or contact your local waste disposal authority for more information on proper disposal of pesticides in your area.

